

# Building Renovation Categories

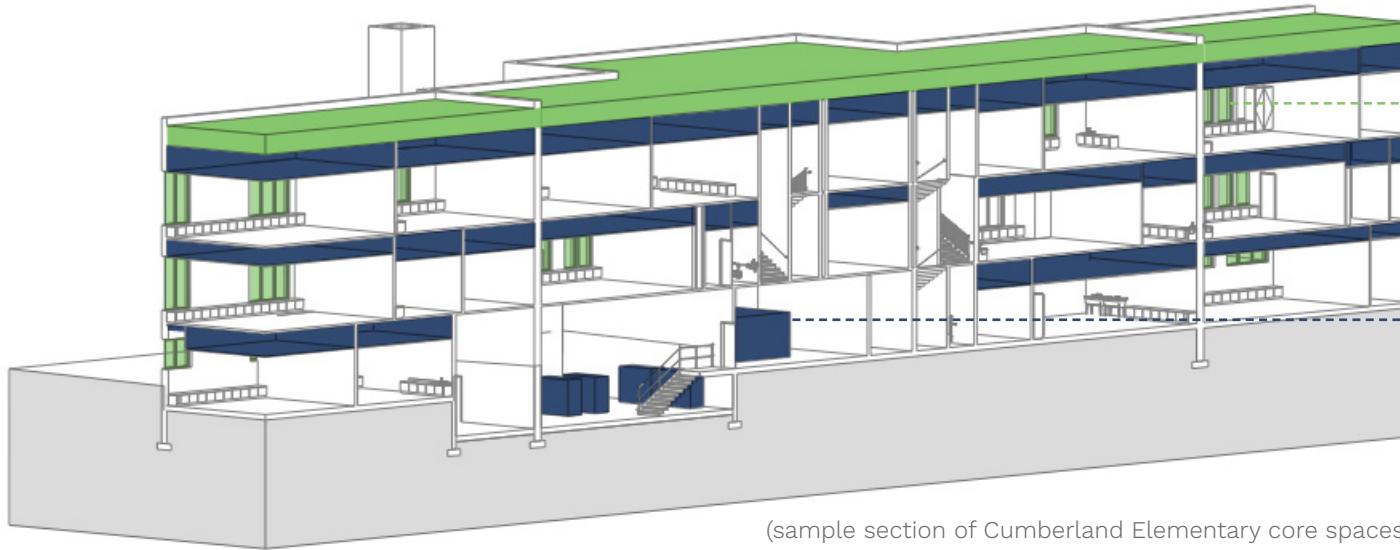

(sample section of Cumberland Elementary core spaces)

**Exterior Envelope Example :**  
Roof Replacement

**Exterior Envelope Example :**  
Window Replacement

**MEP & Fire Protection Example :**  
Ducting and Sprinklers above Ceilings

**MEP Example :**  
Equipment and Controls Replacement

## Mechanical, Electrical & Plumbing (MEP) Systems

includes equipment, distribution networks, and fixtures for each building’s mechanical (HVAC), electrical, and plumbing infrastructure. All buildings would be upgraded to current, high-efficiency HVAC systems and controls, including the addition of air conditioning.

## Fire Protection & Safety/Security

includes sprinklering of all buildings, plus replacement of fire alarm systems (with voice notification and strobes that are now required for accessibility), compartmentalization doors, best practices in secure entries, and additional security measures. Some buildings will receive additional cameras and/or notification system upgrades.

## Building Exterior

includes roof replacements and window replacements as recommended, as well as masonry tuckpointing/cleaning, foundation work, and additional watertightness measures.

## Accessibility

includes projects to ensure students, staff, and visitors have physical access to all public spaces of the building. At the elementary schools this will include shifting the front office to the lower level with entry rework so all visitors can enter at the front.

## Site Improvements

includes additional traffic/site circulation improvements, site safety upgrades, fencing, and drainage/grading projects.



SCAN THE QR CODE or visit [wfbschools.com](http://wfbschools.com) to learn more.



**VOTE BY APRIL 7**